

2 BUCKETS



BUCKETS

2 BUCKETS

KINSHOFER now offers a series of the most reliable and durable buckets available on the market today.

Daily routine tools such as General Purpose or Heavy Duty Digging Buckets are part of the versatile range as well as Ditch Cleaning Buckets, Rakes or Rippers.

Even more flexibility can be achieved thanks to the broad scope of attachments offered by Kinshofer. Using any of these or other attachments with a **KINSHOFER NOX**

Tiltrotator will enable you to work in narrow spaces or on difficult terrain without repositioning your excavator all the time.

Special suitable bucket sets for the **NOX** save money and are perfectly fit for the Tiltrotator.

And for more safety when changing from one application to another: the X-Lock Quick Coupler completes your flexible, safe and effective package.

The different buckets are available for excavators with 13t to 55t operating weight.



X-Lock Quick Coupler

GB GENERAL PURPOSE DIGGING BUCKET

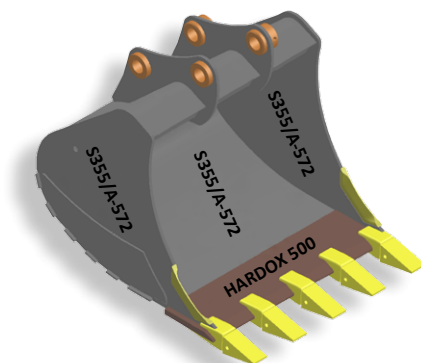

This bucket, the design basis for other styles, is ideally suited for general construction applications with common digging material including soil, dirt and gravel.

FEATURES:

- Robust design includes high strength box section
- Includes high strength and abrasion-resistant steel Hardox 500
 - Tapered and a dual radius shape means less heel drag and wear, improving performance and efficiency
 - High capacity due to deep profile
- Short tip distance means great strength and break-out force
- Various GET available to meet your requirements

DESIGN FEATURES

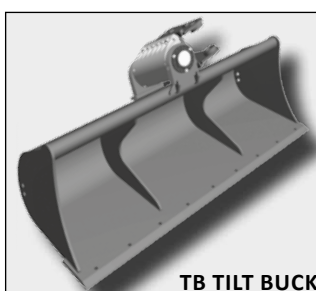
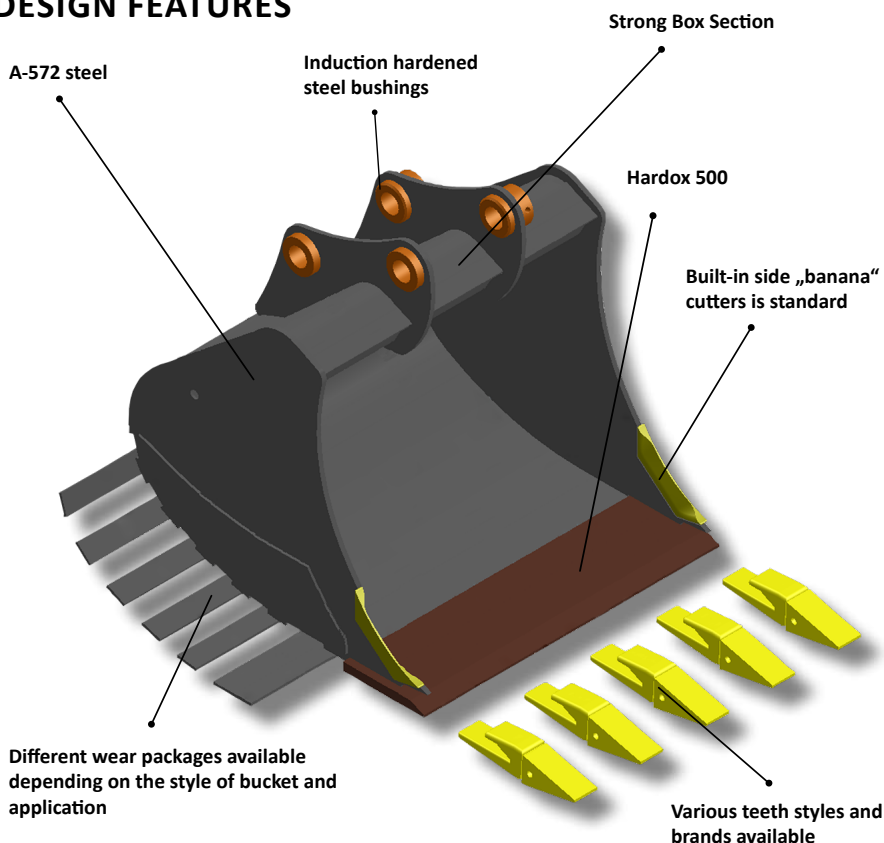

TB TILT BUCKET
More flexibility and maneuverability due to a tilt angle of 140° up to 180°

SK SKELETON BUCKET

For sorting material, e.g. gravel and sand from rock

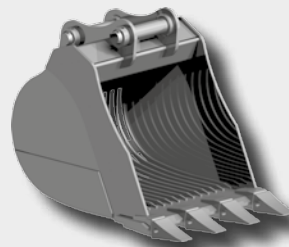

SPECIAL AP

RH RIPPER
For ripping hard or frozen soil



HB HEAVY DUTY DIGGING BUCKET

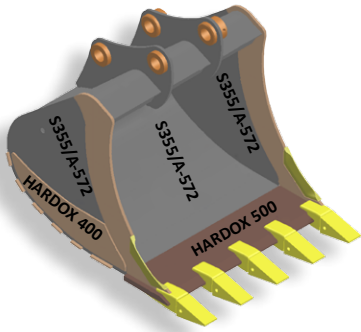

The heavy duty bucket features the same design as the general purpose one, but has been adapted to demanding excavating applications.

FEATURES:

- Robust design includes high strength box section
 - Cast side cutters as standard
- Includes high strength and abrasion-resistant steel including Hardox 400 and 500
 - Side plates made of A-572 steel

DESIGN FEATURES

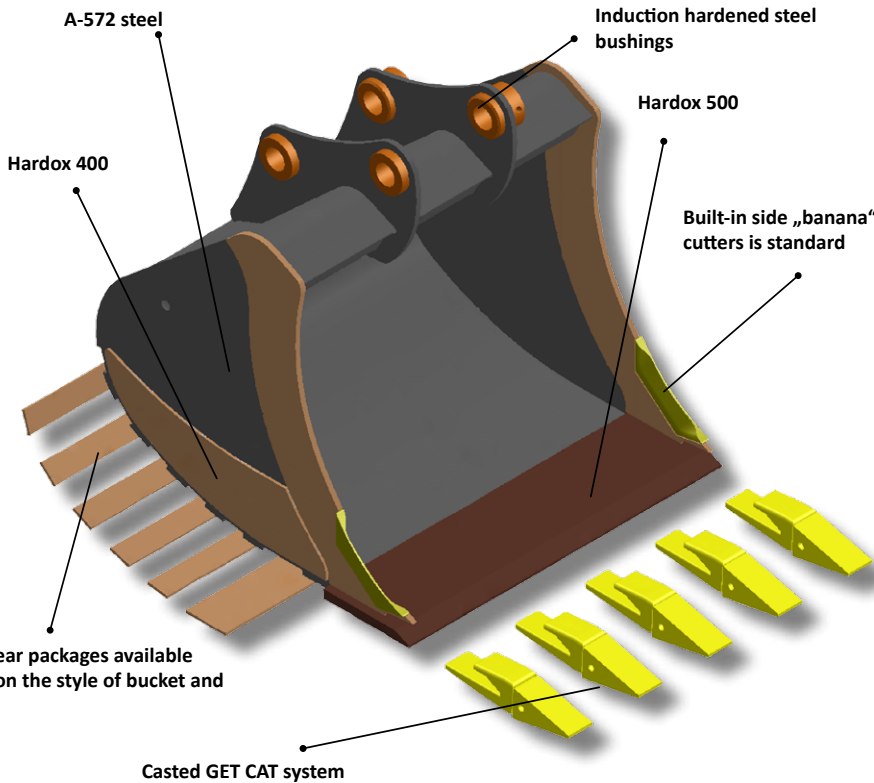

X-LOCK™ Coupler to the attachment

Connect

Safety knuckle in safe position-ready to engage. Buzzer is sounding 1 beep per second because the wedge is retracted.

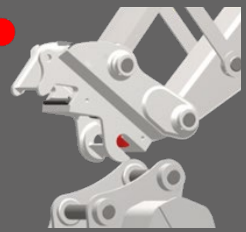

Safety knuckle engages automatically onto front pin, securing the attachment immediately.

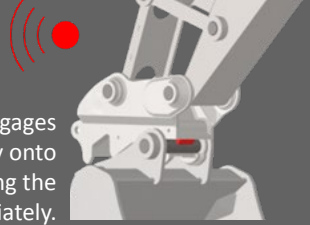

Self-adjusting wedge locks second pin as soon as lock switch is deactivated.

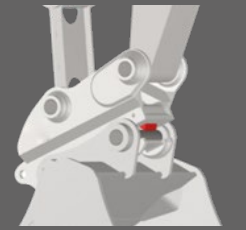

Disconnect

Unlock self-adjusting wedge and disengage coupler from the back pin. Buzzer is sounding 1 beep per second.



Unlock safety knuckle with the switch - buzzer is sounding at 2 beeps a second as the safety knuckle is retracted.



Coupler can be removed from attachment. Buzzer shows that coupler is still open.



After 5 to 10 seconds the safety knuckle re-engages to the safe position.

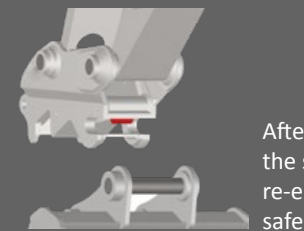

APPLICATIONS

RC CURVED RAKE

For sorting of rocks and gravel, clearing woods or dispose and load green waste

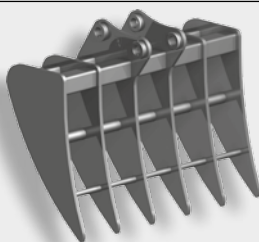
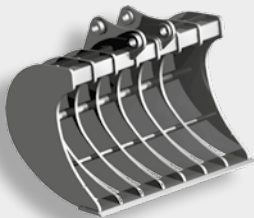

RS STRAIGHT RAKE

For forestry tasks or disposal and loading of green waste

RB ROCK BUCKET

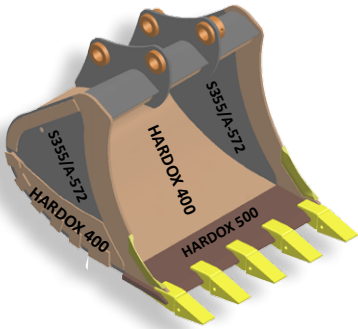

The rock bucket, based on the same general design concepts as the General Purpose and Heavy Duty buckets, is specifically suited for quarry jobs digging loose rock, or other applications where the material is hard and abrasive.

FEATURES:

- Side and bottom wear plates made of Hardox 400 and 500 steel (vertical or horizontal)
- Bottom wear pads
- Robust design includes high strength box section
- Reinforced version
- Casted GET CAT system

DC DITCH CLEANING BUCKET

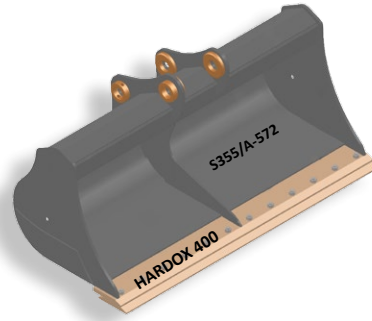

The ideal tool for grading and ditch cleaning tasks – especially in combination with a **nox** Tiltrotator.

FEATURES:

- Robust design includes high strength box section
- Use of high strength and abrasion-resistant Hardox 400 steel in the manufacture of cutting blades
- High capacity due to deep profile
- Short tip distance means great strength and break-out force
- Exchangeable cutting edge

DESIGN FEATURES

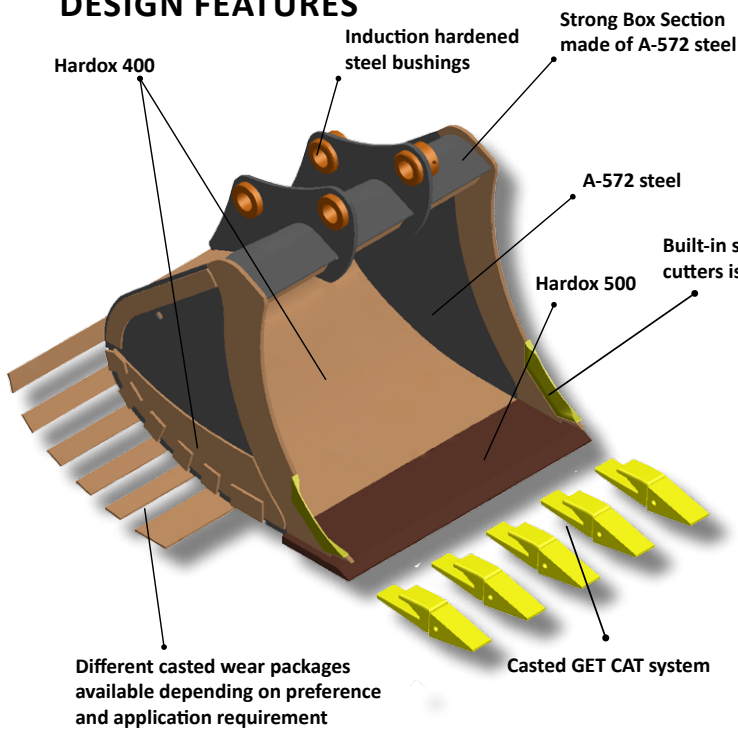

Different casted wear packages available depending on preference and application requirement

DESIGN FEATURES

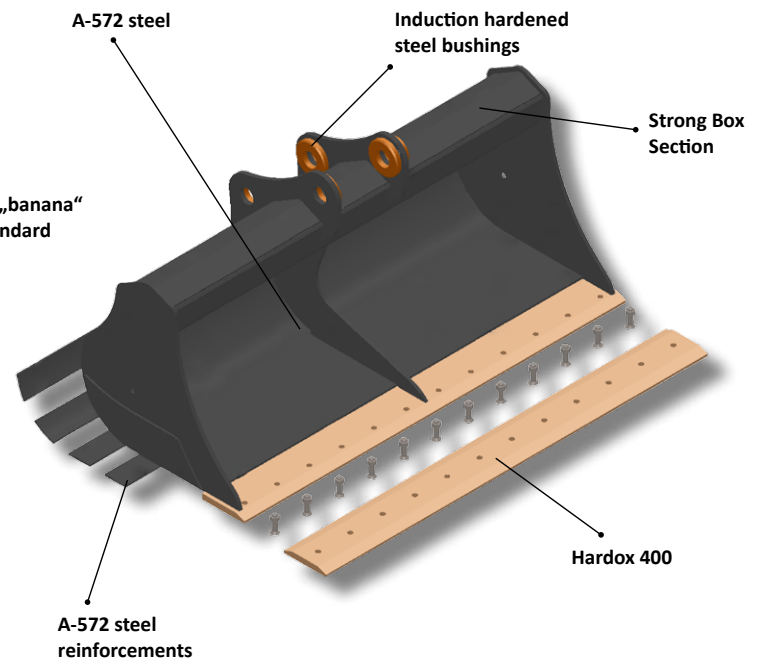

A-572 steel reinforcements

We reserve the right to amend specifications without prior notice. **KINSHOFER** GmbH, Germany

Hauptsitz Deutschland:
KINSHOFER GmbH
Hauptstrasse 76
83666 Waakirchen
Tel.: +49 (0)8021 – 88 99 0
Fax: +49 (0)8021 – 88 99 37
Email: info@kinshofer.com
www.kinshofer.com

France:
KINSHOFER France S.A.R.L.
B.P. 20100
F-67213 Obernai Cedex
Tel.: +33(0) 3 88 39 55 00
Fax: +33(0) 3 88 79 06 75
Email: sales-france@kinshofer.com
www.kinshofer.com

United States of America:
KINSHOFER USA
6420 Inducon Drive
Suite G
Sanborn, NY, 14132
Tel.: +1 (716) 731 4333
Toll Free (North America):
1 (800) 268 9525
www.kinshofer.com

Suomi:
KINSHOFER APONOX Oy
Laajamäentie 1
FI-13430 Hämeenlinna
Tel.: +358 (0)75 7540 200
Fax: +358 (0)75 7540 210
Email: sales-finland@kinshofer.com
www.kinshofer.com

United Kingdom:
KINSHOFER UK Ltd.
4 Milton Industrial Court
Horsfield Way, Bredbury
Stockport, Cheshire, SK6 2TA
Tel.: +44 (0)161 – 406 7046
Fax: +44 (0)161 – 406 7014
Email: sales@kinshofer.co.uk
www.kinshofer.com

Canada:
KINSHOFER North America
5040 Mainway Drive, Unit #11
Burlington, ON L7L 7G5
Tel.: +1 (905) 335 2856
Fax: +1 (905) 335 4529
Toll Free (North America):
1 (800) 268 9525
Email: sales-northamerica@kinshofer.com
www.kinshofer.com

中国:
Darda **KINSHOFER** Construction
Machinery Co. Ltd.
Unit #306, Landmark Tower 2
8 Dongsanhuan Road
Beijing 100004
Tel.: +86 (10) 6590 6422
Fax: +86 (10) 6590 6423
Email: info@darda.com.cn
www.darda.com.cn

Sverige:
RF System AB
Furutorpsgatan 6
SE-288 34 Vinslöv
Tel.: +46 (0)44 817 07
Fax: +46 (0)44 859 63
Email: info@rf-system.se
www.rf-system.se



www.kinshofer.com



KINSHOFER

is an ISO 9001 certified Company.
DVS ZERT is a registered trademark
of DVS ZERT e.V., Düsseldorf.

Upfront, everywhere

KINSHOFER
crane and excavator attachments